

# SD-R2 SD-I4

/  
DOUBLE JERSEY INTERLOCK & RIB  
CIRCULAR KNITTING MACHINE

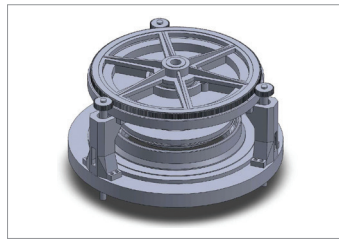

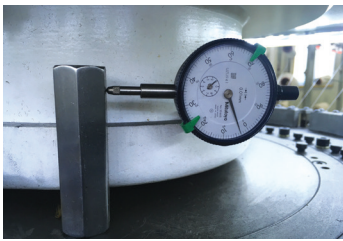
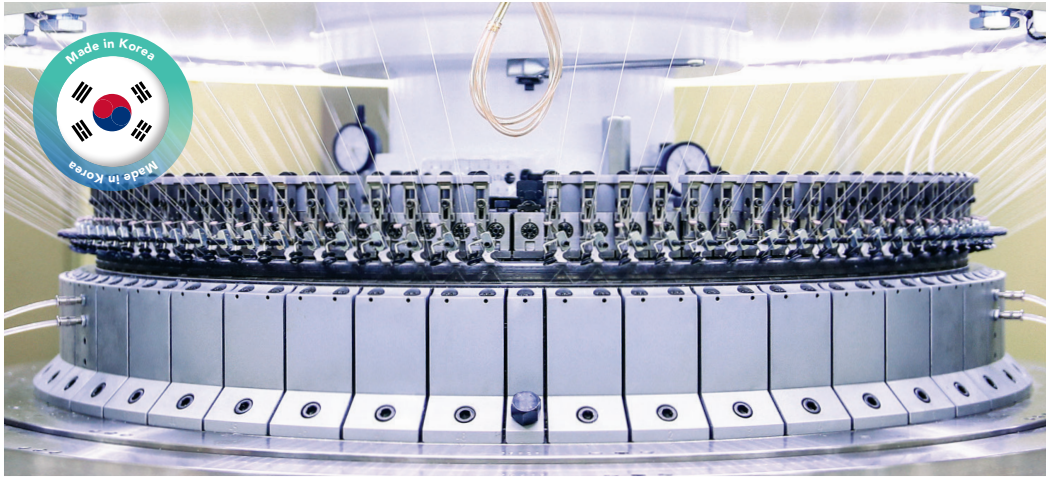

- Two cam rings can adjust the height of the cylinder cam box  
This structure was only applied by SAMES, and it can knit various kinds of fabric materials  
It has already been verified and is favorably received by customers
- The dual arrangement(upper,lower) of the ball race bearings completely block the cylinder clearance
- The three counter gears transmitted to the dial prevent the clearance between the cylinder and the dial
- The top gear and the main shaft do not use a key, therefore they use a separate device to maintain concentricity and planarity accurately
- Convenient for knitting diverse kinds of fabrics using dial 2track and cylinder 4track needles
- Yarn guide made by Zirconia
- 10 Inch touch panel Monitor

Technical Specification

MODEL	INCH	GAUGE	FEEDER
SD-R2	30	12~28	60
	34	12~28	68
	36	12~28	72
SD-I4	30~36	13.5~32	72~84
	30~36	18~42	84~96
	30~36	18~42	96~108
	30~36	20~32	108~126

Dimensions(Include side creel area)

(unit: mm)

Cylinder Diameter	A	B	C	D
28~32"	4,700	3,950	1,950	2,080
34~38"	4,850	3,950	2,070	2,210

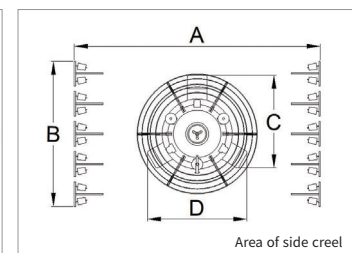
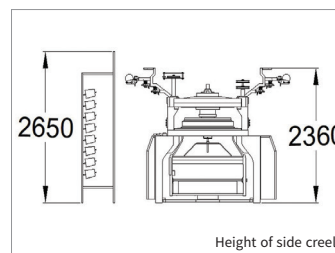

※ Based on 36" × 96F, 31" × 84F

Head Office

88, Jeonggeum-ro 393beon-gil, Gasan-myeon, Pocheon-si, Gyeonggi-do, Republic of Korea  
Tel +82-31-543-8534 Fax +82-31-543-8539 E-mail samesmc@korea.com