

SS-F3 SS-F4 SS-F5

／
SINGLE FLEECE
CIRCULAR KNITTING MACHINE

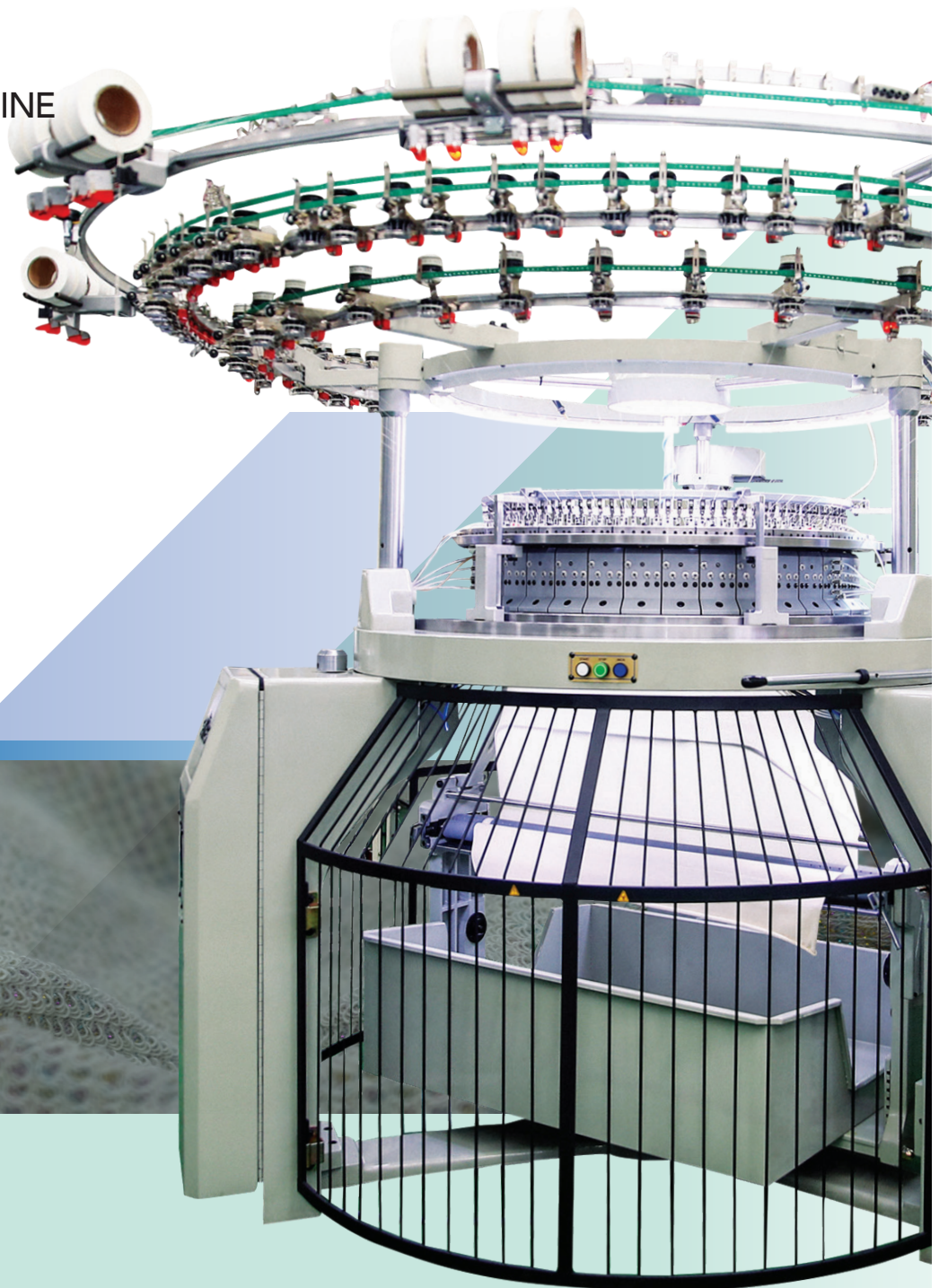

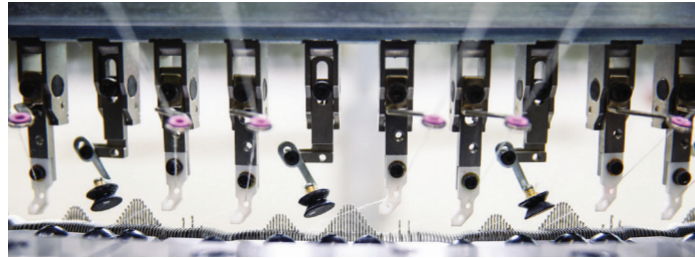
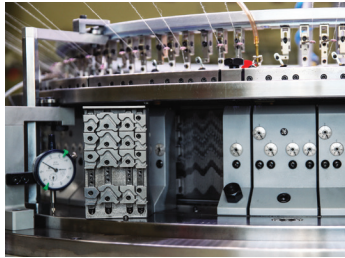
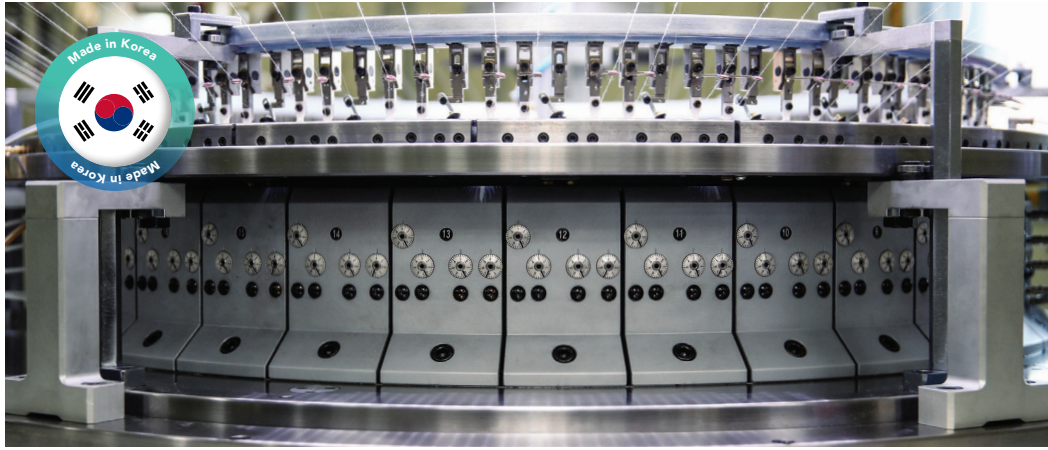

- Central Stitch Control System – Controls a speedy and uniform stitch length
- When adjusting the Sinker cap ring support the concentricity can be maintained and the convenience of use can be promoted with a flexible movement using two-ball bearings that are mounted on six legs
- The stable structure of the machine is suitable for high-speed rotation optimized for the knitted fabric and low maintenance cost
- Application of 5track cylinder cam convenient for diverse fabric knitting
- Provides a bright and convenient work environment through LED lighting
- 10 Inch touch panel Monitor
- **Option : Cylinder needle 3,4 and 5track, Single conversion kit(4 feeder/inch)**



Technical Specification

MODEL	INCH	GAUGE	FEEDER	NEEDLE
SS-F3 SS-F4 SS-F5	26	16~28	72/84	3,4,5 STEPS
	30	16~28	96	
	32	16~28	90/96	
	36	16~28	108	

Dimensions(Include side creel area)

(unit: mm)

Cylinder Diameter	3F / Inch		4F / Inch		C	D
	A	B	A	B		
22~26"	4,830	3,230	4,960	4,570	1,910	2,030
30"	4,940	3,900	5,360	5,240	2,000	2,130
32"	4,990	4,570	5,560	5,910	2,020	2,160
34"	5,040	4,570	5,720	5,910	2,060	2,200
36"	5,090	4,570	5,870	6,580	2,100	2,250
38"	5,140	5,240	6,110	6,580	2,130	2,280

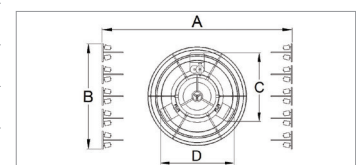
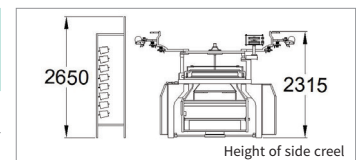

Head Office

88, Jeonggeum-ro 393beon-gil, Gasan-myeon, Pocheon-si, Gyeonggi-do, Republic of Korea
Tel +82-31-543-8534 Fax +82-31-543-8539 E-mail samesmc@korea.com